

# Village of Bartlett



## OVERHEAD SEWER PROGRAM VILLAGE COST SHARE UP TO \$10,000

### IN ORDER TO QUALIFY FOR THE VILLAGE OF BARTLETT'S OVERHEAD SEWER COST SHARING PROGRAM:

The perimeter drain tile and any other source of storm water must be disconnected from the Village sanitary sewer. Installation of a sump pit and sump pump is required, if not presently and correctly installed. The sump pump is to discharge the storm water onto the ground, to the front or rear of the property, and at a point No Closer than 10' from any property line. The sump pump must never discharge onto any public sidewalk or parkway. The sump pump discharge may be connected to the storm sewer in the street via underground pipe, SDR 26 PVC minimum 4" diameter. If additional storm water is being conveyed (such as rear yard drain or downspouts) then use a 6" diameter SDR 26.

Note: This requirement is not applicable if the proper sump pit for perimeter drain tile already exists. Tree roots or any dry-weather back-up does not qualify, but may qualify for the Lateral Cost Sharing Program through the Village.

# **BARTLETT OVERHEAD SEWER PROGRAM**

## **Table of Contents**

	<b>Page</b>
<b>Program Description</b> _____	3-4
1. What is it? _____	3
2. How Does the Overhead Sewer Work? _____	3
3. Is There Anything Else I Should Know? _____	3-4
3a. Eligible Costs _____	4
3b. Non-Eligible (Resident Responsibility) Costs _____	4
<b>Sketch A: “Before” – Typical Gravity Sewer System</b> _____	5
<b>Sketch B: “After” – Typical Overhead Sewer System</b> _____	6
<b>General Plumbing Notes</b> _____	7
<b>Instructions on How to Apply</b> _____	8
<b>Example Attachments</b> _____	9-12
Attachment A: Overhead Sewer Permit Application _____	9
Attachment B: General Information Form _____	10
Attachment C: Letter of Agreement _____	11
Attachment D: Example of Required Informaiton in Contractor Quote _____	12

Revised: 7/10/2020  
Adopted: 3/5/2019

# **BARTLETT OVERHEAD SEWER PROGRAM**

## **1. What is it?**

The Village of Bartlett Overhead Sewer Program was established to provide financial assistance to homeowners who desire to protect their home from flooding during a heavy rain event. Eligible homeowners may qualify for the Village to pay up to \$10,000 towards the cost for installing an overhead sewer system, which can protect their basements from sewer back-up. Some “modified” overhead sewer designs may also qualify upon review and approval of Village Staff.

## **2. How Does the Overhead Sewer Work?**

Typically, homes which have experienced sewer back-ups and flooded basements during a heavy rain event have a gravity type sewer (Sketch “A” on page 5). The existing sewer underneath the basement floor drains to the sewer in the street by gravity. When the Village sanitary sewers become overloaded due to the rain, the gravity type sewer is subject to back-up.

Changing the basement plumbing system to an Overhead Sewer (Sketch “B” on page 6) can protect the basement from back-ups. Basically, the plumbing in the basement gets re-plumbed and directed to an ejector pit. The ejector pit lifts the sewage up and overhead, then down to about mid-height of the basement wall, where it exits the foundation wall to the outside of the building. Once outside, there is a “steep slope” section of pipe where it continues to the lateral line and then to the Village sewer main. If the Village sewer main backs-up, the homeowner is better protected, as the water will most likely only back-up into the “steep slope” area of the pipe, and not into the house.

## **3. Is There Anything Else I Should Know?**

In order to qualify for this program, the proposed Overhead Sewer remedy by your licensed (both with the State and the Village) plumber must accomplish several things:

Firstly, this program is only available to **owner-occupied, single-family homes** who have experienced sanitary sewer backups from the Village mains. Rental, multi-family and commercial properties are not eligible. Homes that have had backups from problems in the home service line (such as roots in the line) are **not** eligible for the overhead sewer program, but may qualify for participation in the Lateral Service Line Cost Sharing Program provided through the Village.

Secondly, the perimeter drain tile and any other source of storm water must be disconnected from the sanitary sewer. Installation of a sump pit and pump is required, if not presently and correctly installed. The sump pump is to discharge the storm water onto the ground, to the front or rear of the property, and at a point NO CLOSER than 10’ from any property line. The sump pump must never discharge onto any public sidewalk or parkway. The sump pump discharge may be connected to the storm sewer in the street via underground pipe, SDR 26 PVC minimum 4” diameter. If additional storm water is being conveyed (such as a rear yard drain or downspouts) then use a 6” diameter pipe SDR 26. Please note: this requirement is not applicable if a proper sump pit for perimeter drain tile already exists and no storm connections to the sanitary exist.

## **BARTLETT OVERHEAD SEWER PROGRAM**

Also, an overhead sewer needs to be installed per Sketch B (see page 6). The plumber needs to provide two (2) sets of drawings which communicate all of the work being performed. A detailed and itemized invoice (Example on page #) for all work being performed is required to be submitted to the Village for review and approval by Village Staff (modified overhead sewer designs may also qualify depending on Staff review). The plumber must also provide a copy of the televising footage on USB to the Bartlett Wastewater Supervisor, proving that all storm connections are disconnected for the sanitary lateral line and sanitary sewer main **Prior to the start of the project. The first plumber to the home for a quote is required to provide the televising and that video shall be distributed for the other plumbers. The resident will be required to pay that portion, but it will be included in a portion of the reimbursable costs to the resident after completion of the overhead sewer.** If further evidence is required, the Owner may have to have the Contractor dig on the outside of the foundation to prove there are no storm connections.

The resident interested in obtaining this assistance must provide three (3) quotes from licensed plumbers in order to potentially qualify for the Village sharing in the cost. **The resident may choose whichever of the three (3) contractors they would like to use; however, the Village will reimburse based off the LOWEST accepted quoted price.** Furthermore, there are certain costs which are eligible for the Village Overhead Sewer Program and others that are not.

### **Eligible Costs (Up to \$10,000) are as Follows (Must be included on Estimate):**

- **Costs of initial televising of the sanitary service line to prove no storm connections or tree root damage.**
- Cost of a ejector pump and associated electrical and plumbing work needed to lift sanitary drainage from basement plumbing fixtures to an overhead sewer.
- Applicable permit fees.
- Costs of location, excavation and exposure of the house lateral sewer line including the support of existing structures for re-connection of a new overhead sewer to the existing lateral.
- Cost of trenching and concrete floor repairs associated with the Overhead Sewer repairs.

### **Residents Costs may not all be applicable, but if applicable, must be on estimate:**

- Cost of a new sump pit and pump or associated piping pits or materials.
- Cost of grass seeding to restore disrupted grass/lawns.
- Battery backup system for the new sump pump
- Removal and Replacement of interior walls and finishes.
- Use of materials not meeting the requirements of the Village's guide specifications or Village codes.
- Ancillary homeowner improvements not necessary to provide sanitary sewer back-up protection of the basement.
- Planting or replacement of new landscaping (bushes, trees, sod, fences, walls, etc.)
- New electrical panels and/or upgrading the house electrical supply.

# BARTLETT OVERHEAD SEWER PROGRAM

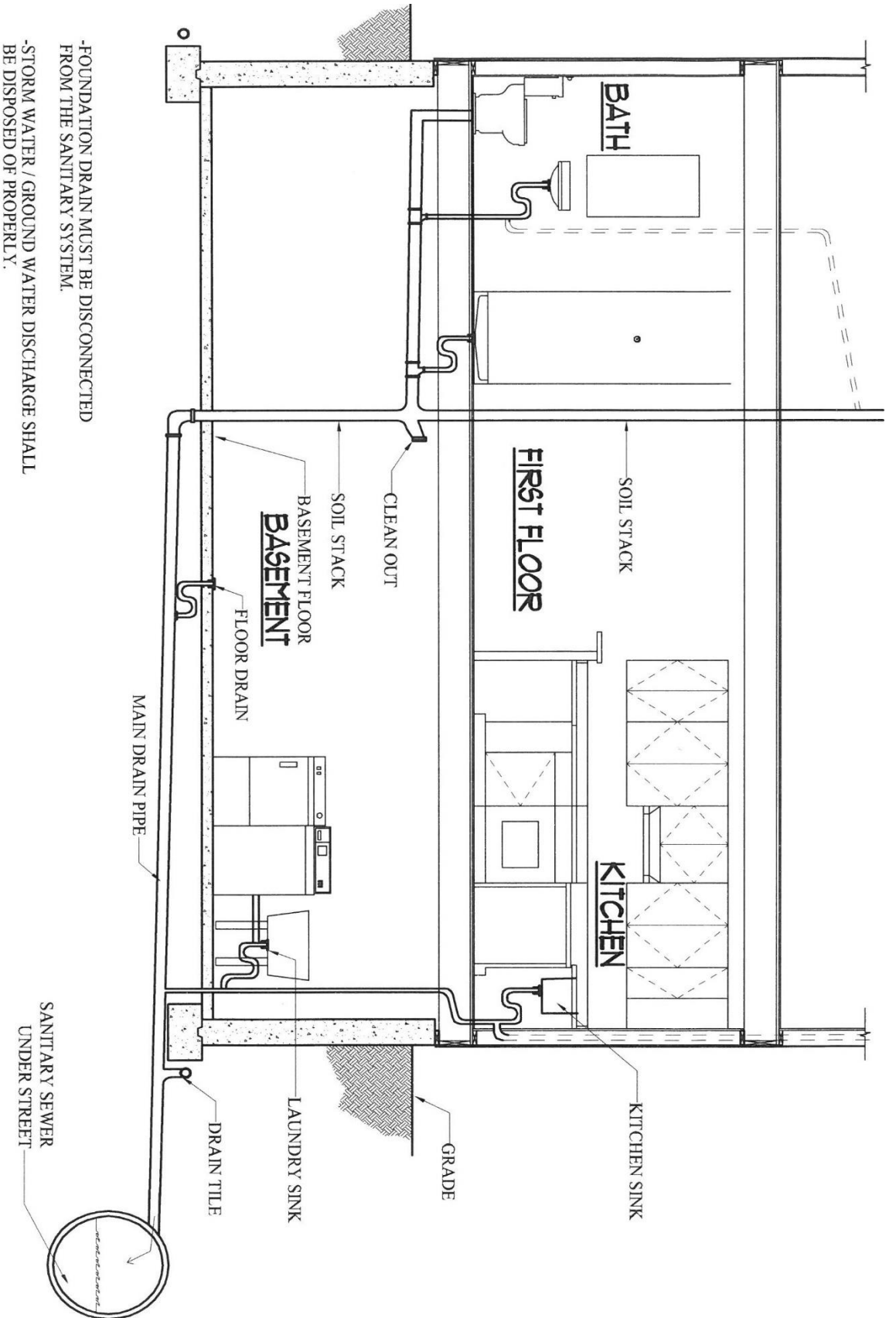

-FOUNDATION DRAIN MUST BE DISCONNECTED FROM THE SANITARY SYSTEM.

-STORM WATER / GROUND WATER DISCHARGE SHALL BE DISPOSED OF PROPERLY.

-IN SOME HOMES, THE BASEMENT WASH TUB, FLOOR DRAINS AND KITCHEN PLUMBING MAY DISCHARGE TO AN EXTERIOR CATCH BASIN LOCATED BEHIND OR ALONG SIDE THE BUILDING

-SOME HOME MAY ALSO HAVE A FOUNDATION DRAIN WITH A GRAVITY CONNECTION TO A SUMP PUMP IN THE BASEMENT

## BEFORE

SKETCH A : EXAMPLE OF A TYPICAL GRAVITY DRAINAGE SYSTEM

# BARTLETT OVERHEAD SEWER PROGRAM

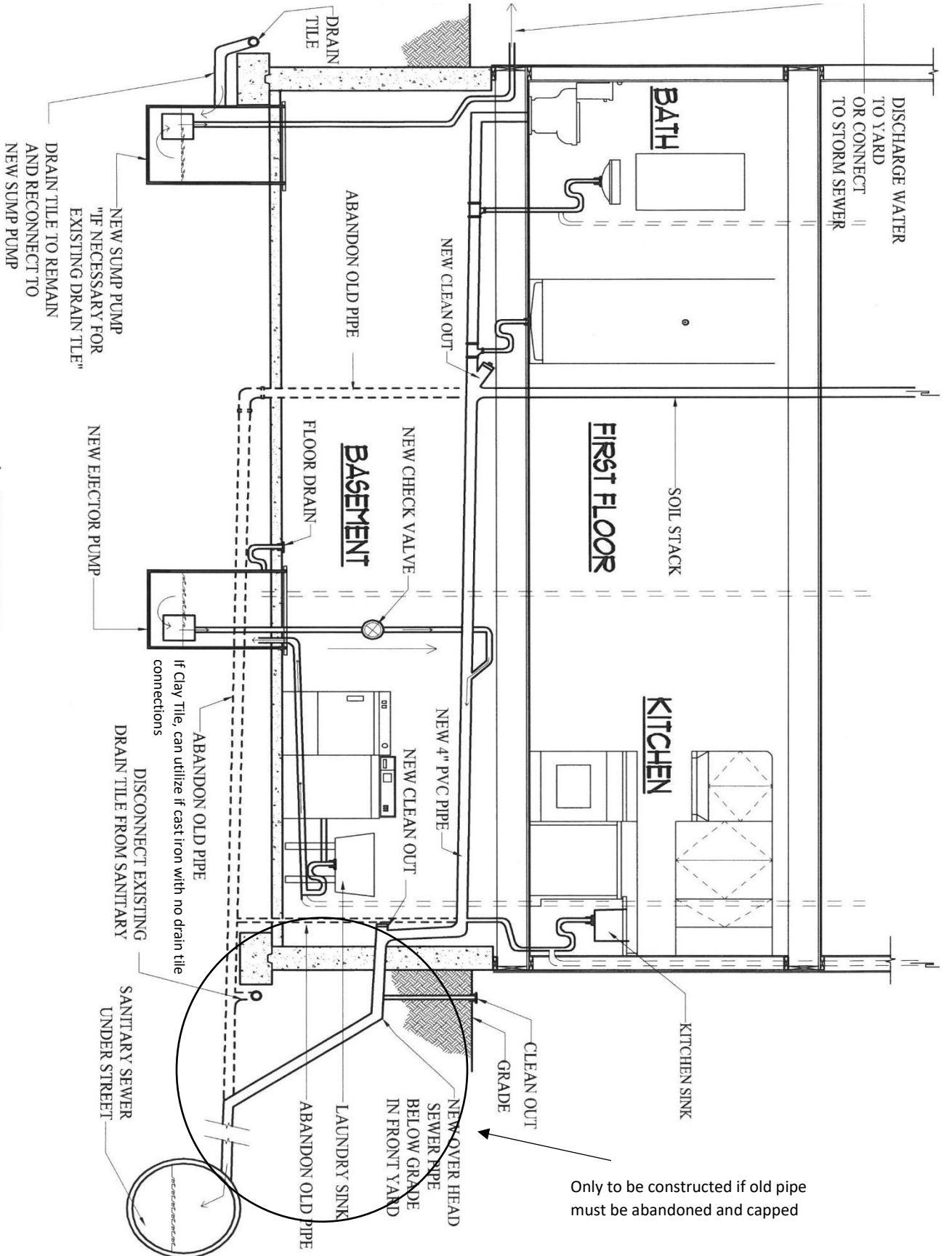

Only to be constructed if old pipe must be abandoned and capped

## AFTER

SKETCH B: EXAMPLE OF A CONVERSION TO AN OVERHEAD SEWER SYSTEM

# **BARTLETT OVERHEAD SEWER PROGRAM**

## **GENERAL PLUMBING NOTES**

1. In order to qualify for the Overhead Sewer Program Cost Sharing: The perimeter drain tile, storm water, must be disconnected from the sanitary sewer. Installation of a sump pit is required to discharge the storm water on the ground (front or back) or make a direct connection to the storm sewer in the street. Sump pits must never discharge onto sidewalk or the parkway. A copy of the video from the plumber (on USB) is required to show no storm water discharge connections into the sanitary line.
2. **All plumbing within the home must be up to code and if any renovations have been done in the home without a permit, a permit must be obtained and approved prior to any cost sharing with the Village.**
3. Use SDR 26 ASTM 2241 for Sewer Pipe. If there is less than a 10'-0" separation of water service to any sewer line, the installation shall comply with section 890.1150 20 Appendix A Table A (Approved Building Drainage/Vent Pipe) for a building drain. 2014 State of IL. Plumbing Code.
4. Where manufactured pipe joints cannot be utilized or where dissimilar materials are joined, "non-shear" type couplings shall be used for connections.
5. Connections of SDR 26 laterals to VCP/SDR 26 PVC sanitary sewer main or CP storm sewer shall be made with a stainless-steel band and gasketed saddle connection.
6. Disconnect abandoned basement floor drains/sewer outside of building foundation/slab and cap with the use of brick and hydraulic cement.
7. All floor drains must be vented per Village ordinance 9-10-10 B, a floor drain shall be installed within six feet (6') of the water heater(s) furnace area and in the same room as these appliances.
8. PVC pipe for drain waste and vent is permitted for use above ground and is permitted underground and under the slab inside the building.
9. The overhead sewer must penetrate the foundation wall before it starts its steep slope. To provide optimal protection the new overhead sewer SHALL NOT be connected to the existing gravity sewer inside the basement in the event that the original pipe is clay-tile.
10. Provide a clean-out just outside of the building if digging near the foundation is required.
11. The Contractor shall restore all interior and exterior surfaces disturbed due to excavation in-kind.
12. The application shall include a detailed description of exterior extent of work.

# **BARTLETT OVERHEAD SEWER PROGRAM**

## **INSTRUCTIONS ON HOW TO APPLY**

### **Step 1:**

- Contact the Public Works Department Wastewater Division at 630-837-0811 to:
  - Get your name on the list of applicants.
  - Schedule a meeting with Wastewater Division Staff and the Plumbing Inspector to make sure the property is eligible
    - **If eligible, Plumbing Inspector shall detail what is required to be done.**

### **Step 2:**

- After being deemed eligible:
  - **Have first licensed plumber televise line and provide a USB copy of the line to the Village of Bartlett for inspection and approval that no storm connections exist**
  - Obtain three (3) quotes from licensed plumbers and obtain Village Staff approval
  - Hire the approved plumber

### **Step 3:**

- Prepare to submit the following:
  - The hired plumber prepared drawings and provided written proposal, which details the scope of work.
  - **Overhead Sewer Permit Application** (page 9)
  - **General Information Form** (page 10)
  - **Letter of Agreement** (page 11)
- If there are no storm connections into the sanitary line, have the plumber provide a copy on USB of the televised sanitary line to the Wastewater Division for review.
- Submit the drawings, proposal and forms (and video if applicable) to the Bartlett Public Works Department at 1150 Bittersweet Drive.

\*All assistance with Overhead Sewer is based on available and budgeted funds\*

### **Step 4:**

- The drawings, proposal and video will be reviewed and will either be approved as noted or returned for revisions. When drawings and proposal receive approval, the permit will be issued and the plumber can start the work.

### **Step 5:**

- The plumber needs to contact the Wastewater Division and the Building Department to schedule normal inspections during the course of work and at completion for a final inspection.
  - Note: If there were originally storm water connections into the sanitary line, the plumber must remove those connections and provide a televised copy (on USB) of the remedied sanitary line to the Wastewater Division for approval, and shall be inspected and approved by the Building Department before any payment can be processed.

### **Step 6:**

- After the work has been inspected and approved, the Village will pay for the eligible Overhead Sewer Program Costs as stated on page 4.



Permit #: \_\_\_\_\_

- Inspected for Eligibility \_\_\_\_\_ (Initials/Date)

Village of Bartlett Public Works  
1150 Bittersweet Dr. Bartlett, IL 60103  
630-837-0811

# OVERHEAD SEWER PROGRAM PERMIT APPLICATION

Must submit two (2) sets of all drawings

Owner Name: \_\_\_\_\_ Date: \_\_\_\_\_

Address: \_\_\_\_\_ Phone: \_\_\_\_\_

### ALL CONTRACTORS/HOMEOWNERS TO PROVIDE SEPARATE TRADE SPECIFIC BONDS

<b>* Include Name, Address, City &amp; Zip Code *</b>	<b>Phone Number</b>
<b>Plumber:</b>	
<b>Sewer &amp; Drain:</b>	
<b>Electrician:</b>	
<b>Street Patching:</b>	

Approximate Job Cost: \$ \_\_\_\_\_

### Plumbing Contractor (Please Print):

Contact: \_\_\_\_\_ Office #: \_\_\_\_\_

Address: \_\_\_\_\_ Cell #: \_\_\_\_\_

1. The perimeter drain tile and any other source of storm water must be disconnected from the Village sanitary sewer, with video proof of disconnection provided by the contractor. Installation of a sump pit and pump is required. The sump pump is to discharge the storm water onto the ground, to the front or rear of the property. The discharge must never be onto public sidewalk or parkway. The sump discharge may be connected to the storm sewer in the street via underground pipe, SDR 26 PVC minimum 4" diameter. If additional storm water is being conveyed (such as a rear yard drain or downspout) then use a 6" diameter pipe SDR 26. (Note: This requirement is not applicable if a proper sump pump pit for perimeter drain tile already exists.)
2. Use SDR 26 ASTM 2241 for sewer pipe. SDR 25 or equal must be used if these is less than a 10ft separation to the water service.
3. Where manufactured pipe joints cannot be utilized or where dissimilar materials are joined, "non-shear" type couplings shall be used for connections.
4. Connections of SDR 26 laterals to VCP/SDR 26 PVC sanitary sewer main or CP storm sewer shall be made with a stainless steel band and rubber gasket saddle connection.
5. Disconnect abandoned basement floor drain/sewer outside of building foundation/slab and cap with use of brick and hydraulic cement.

**Approved as Noted:** \_\_\_\_\_  
Wastewater Supervisor Date

**Approved as Noted:** \_\_\_\_\_  
Plumbing Inspector Date

**Approved as Noted:** \_\_\_\_\_  
Public Works Director Date

# BARTLETT OVERHEAD SEWER PROGRAM

## GENERAL INFORMATION

Name: \_\_\_\_\_

Address: \_\_\_\_\_

Phone: Home or Cell: \_\_\_\_\_ (Work): \_\_\_\_\_

Date you moved into this home: Month: \_\_\_\_\_ Year: \_\_\_\_\_

Plumbing Contractor's Name: \_\_\_\_\_ Cell #: \_\_\_\_\_

Are your downspouts connected to the Village's sanitary sewer system?

Are your downspouts connected to the Village's storm sewer system?

Does your home have an outside catch basin?

Does your home have exterior foundation perimeter drain tile?

Y	N	Unsure

Please check all the plumbing fixtures that are present in the basement of your home:

Floor Drain                       Shower or Tub                       Bathroom

Laundry sink or wash basin    Ejector pump    Toilet

Sump pump:

Discharge Point (Circle): Front   Rear   Side   Connected to Storm Sewer   Unsure

During heavy rains, how many basement water events have you experienced?

\_\_\_\_\_ \*If back-ups occur during dry event, may qualify for Lateral Cost Sharing Program\*

### Application Materials Required:

Each of the following documents **MUST** be attached to this application in order for the application to proceed and for a permit to be issued:

1. Three (3) Quotes for the work from Licensed Plumbers.
2. Copy of detailed proposal from the plumbing contractor who will perform work.
3. Copy of the signed Homeowner Participation Agreement
4. Completed Permit Application form (with all applicable fees paid).

# BARTLETT OVERHEAD SEWER PROGRAM

## Village of Bartlett Letter of Agreement

**I understand and agree** that the Village of Bartlett established the Overhead Sewer Program (“the Program”) to assist residents in protecting their home from flooding due to sewer backups during a heavy rain event.

**Prior to the installation** of any plumbing work, the specific plans including the Proposal shall be submitted to the Village for review and approval. No work shall commence until Village approval is obtained and a permit is issued. The Village shall be notified to inspect the plumbing and electric work as required under any permit.

**The Village will pay the eligible costs** outlined in the Program Description at approved amounts, not to exceed \$10,000.00, and will be made after work is completed, inspected and approved by the Village. No payment will be made to the contractor until after a final inspection is completed by the Bartlett Building Department. I understand, I, the Homeowner, am responsible for all other costs associated with the work.

**Liability** – The Village shall have no liability for any defective work or other damage, injury and/or loss on account of any act or omission of the Contractor in the performance of the work. The Homeowner shall make any claim for such matters directly against the Contractor or Contractor’s insurance carrier. Homeowner hereby agrees to indemnify and hold Village harmless against any and all claims and further covenants not to sue the Village for any and all claims, as no system is absolutely fail safe.

**After payment has been made to the contractor**, the installed overhead sewer system becomes the property of the Homeowner. All expenses pertaining to the ongoing operation and maintenance of the overhead sewer system, including but not limited to all pumps, piping, plumbing fixtures and electrical wiring installed are the property and responsibility of the Homeowner. Maintenance of said equipment is the sole responsibility of the Homeowner.

**Disclaimer** – The Program is designed to substantially reduce the risk of basement backups. However, there is always some risk of basement backup as a result of unexpected sewer collapse, obstruction, power failure, extreme environmental conditions or other unforeseen factors. Proper operation of foundation drains is necessary to prevent seepage of ground water through walls below grade. Existing foundation drains shall not be tested for proper operation in the Program; the Homeowner has the responsibility for all testing, inspections and any corrective work that may become necessary. (The Homeowner is reminded that footing drains, storm water tiles and all perimeter drains must be disconnected from the sanitary system, with video proof of disconnection provided by the plumber. Storm water/ground water discharges shall be disposed of properly)

In addition, reliable continuous functioning of Homeowner’s sump/ejector pump(s) is necessary for overhead sewers, and foundation drains to function properly. The Homeowner shall have the responsibility to check the operation of the pumps regularly. The Homeowner shall have the responsibility for all testing, inspections and any corrective work that may become necessary for regular and periodic maintenance. It is further recommended that the Homeowner install a battery backup system to provide protection in the event of power failure. Costs of a battery backup system shall be the responsibility of the Homeowner.

**Breach** – If the Homeowner fails to comply with all requirements of this Agreement or to complete installation as provided in this Agreement, the Village shall have no obligation to pay for the costs of the overhead sewer.

I understand and agree with all of the above statements and agree to comply accordingly.

---

Homeowner – Printed Name	Signature	Date
--------------------------	-----------	------

---

Property Address

# **BARTLETT OVERHEAD SEWER PROGRAM**

## **EXAMPLE OF REQUIRED QUOTE ITEMS\***

**Must Be on Contractor's Official Estimate Sheet (May be Typed or Handwritten)**

Resident Name	QUOTE #
Address	Contractor Info.
Resident Contact Information	
<b>Detailed Description of the Work to Be Performed</b>	
<b>MUST BREAK DOWN LINE ITEMS FOR CLARIFICATION (If unstated it will not be eligible for reimbursement)</b>	
<b><u>Items from Page 4 that MUST be included on quote:</u></b> (If a requirement is not applicable, state "Not Applicable")	
• Ejector Pump Installation and tie in of all interior plumbing (required)	Reimbursable
• Associate electrical work with the ejector pump installation	Reimbursable
• Costs of location, excavation and exposure of the house lateral sewer line for reconnection of a new overhead sewer	Reimbursable
• Cost of trenching and concrete floor repairs associated with the Overhead Sewer repairs	Reimbursable
• Any permit fees related to the Overhead Sewer Installation	Reimbursable
• New Sump pump installation and sump pit	Homeowner
• Disconnection of storm sewers/drain tile from sanitary service	Homeowner
• Restoration of landscaping outside of home	Homeowner
• Misc. Repairs necessary to complete interior plumbing	Homeowner

### **TOTAL COST FOR ENTIRE OVERHEAD PROJECT**

\*Additional work items requested by homeowner that may not have to do with the overhead sewer project as detailed by the Plumbing Inspector must be completely separated from the overhead sewer quote, or it will be automatically rejected by the Village of Bartlett

\*The resident may elect to hire any licensed and bonded contractor of their choosing to perform the work, however, the Village will ONLY reimburse up to the LOWEST quoted amount.

\*All Plumbing and other renovations must be made up to the current Village Code with appropriate permits (permits related to overhead sewer are reimbursable) in order to qualify for the program.